

ITT

Commercial Water

Goulds Pumps

ICS Dimension
Print

**Stainless Steel Close-Coupled
Centrifugal Pumps 3 HP**

ENGINEERING DATA

Clockwise Rotation Viewed from Drive End	Installation Drawing No. 119-61	Certified for construction purposes <input type="checkbox"/> For Approval <input type="checkbox"/> For Record
		By _____

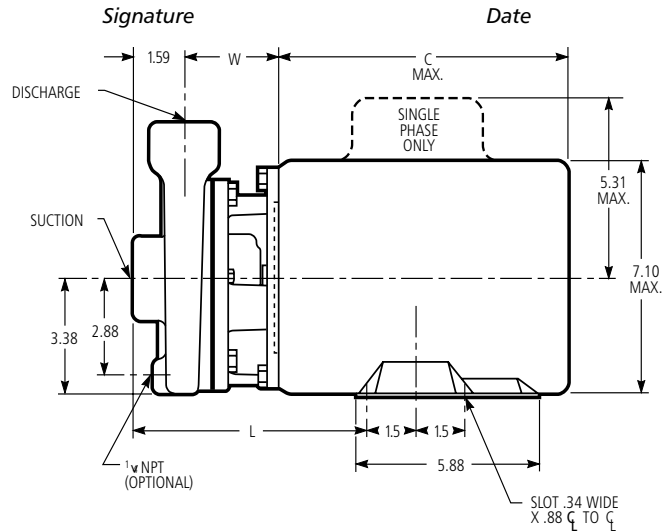
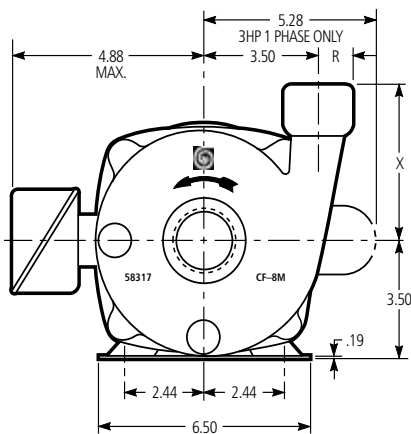

WEIGHTS & DIMENSIONS – DETERMINED BY PUMP

Pump	Suct. NPT	Disch. NPT	L	R	W	X	*Wt. Max.
1 x 1¼-5	1¼	1	7.35	.94	3.01	4.62	17
1¼ x 1½-5	1½	1¼	7.22	1.06	2.88	4.56	17

NOTES:

- Pumps will be shipped with top vertical discharge as standard, for other orientations, remove casing bolts, rotate to desired position, and tighten 3/8" bolts to 24 lbs.-ft.
- Dimensions in inches, weight in pounds.
- Not to be used for construction purposes unless certified.
- Motor dimensions may vary with motor manufacturers.

* Weight is liquid end only. For complete pump, add weight of applicable motor.



Goulds Pumps is a brand of ITT Corporation.

www.goulds.com

Engineered for life

AVAILABLE MOTOR WEIGHTS

HP	Motor Weights				C Max. Length
	1 Phase		3 Phase		
	ODP	TEFC	ODP	TEFC	
3	40	45	42	37	12 1/16

Goulds Pumps and the ITT Engineered Blocks Symbol are registered trademarks and tradenames of ITT Corporation.

SPECIFICATIONS ARE SUBJECT TO CHANGE WITHOUT NOTICE.

DGLICS-2 March, 2008

© 2008 ITT Corporation